



ATLAS TABLE LAMP

The Atlas Table Lamp is a truly unique table lamp, that beautifully combines brass with leather features. A tripod stand with circular neck crafted from sturdy brass and perfectly stitched leather, effortlessly holds the body of the lamp which is fully adjustable in any direction. Constructed from solid brass and finished in an antique brass finish (shown with a fabric shade – not included but we can help you source), the Atlas Table Lamp is an eccentric, sophisticated lamp that will turn heads.

Dimensions

Height: 656 mm

Base width: 104 mm

Shade diameter (base): 132 mm

Technical Details

Lamp Type	1 x UK E14, 1 x E14 EU, 1 x E12 US 240v/110v
Finish Options	All metal finishes available and choice of leather colours
Lamp Type Energy Saving	LED only
Lead Time	4 - 6 weeks

Similar Lamp Options



Napier Table Lamp



Regent Column Lamp

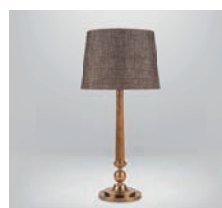

Bamboo Floor Lamp



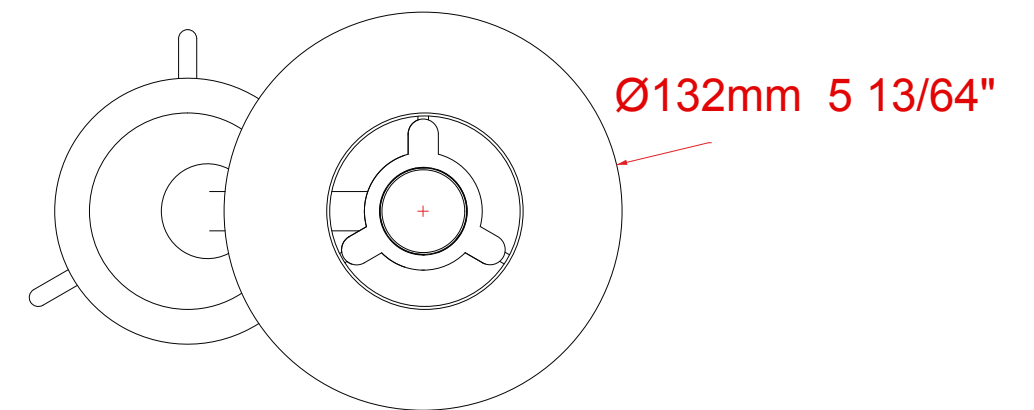
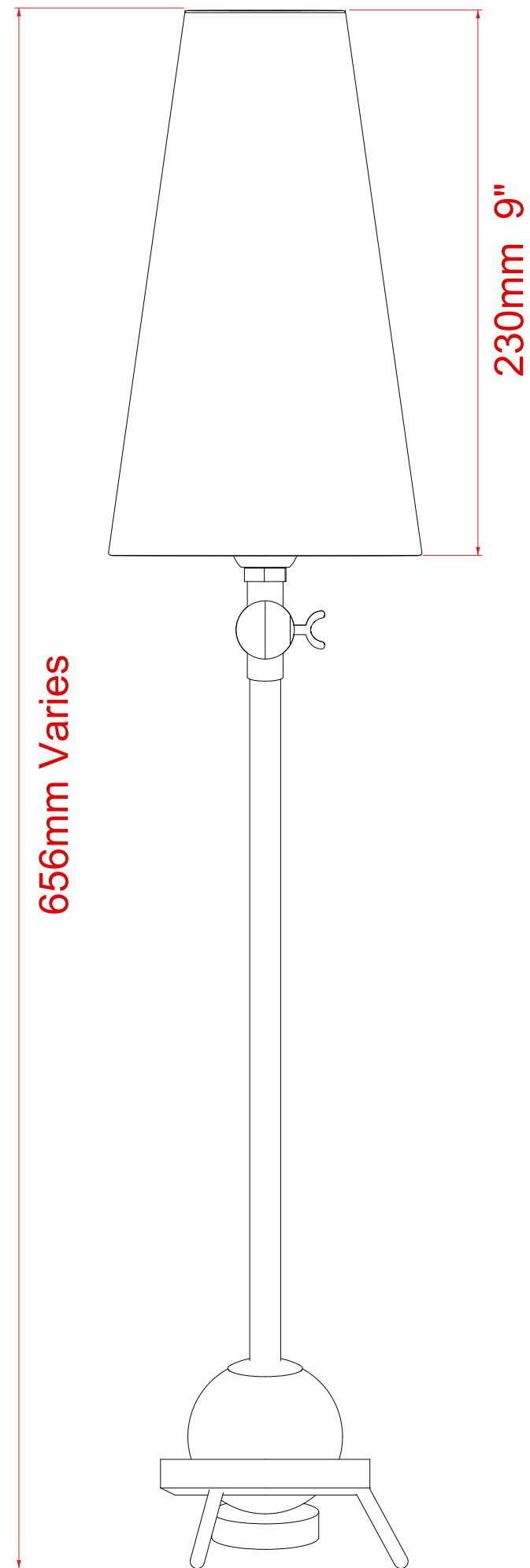
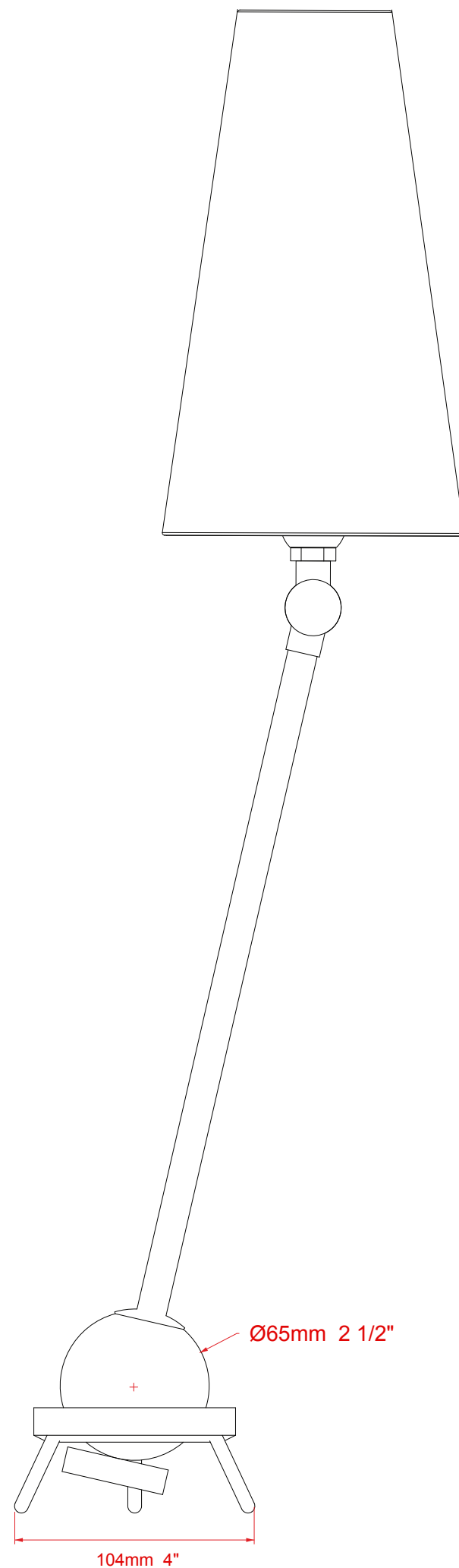

Drawing Name:

Atlas Table Lamp

Material: Brass and Leather

